

iSafePro 360 – Digitouch

High Security Biometric Reader



inside/outside



Digitouch is a **biometric fingerprint reader** capable of recognising up to 500 users (up to 2 fingerprints per user) in standalone mode or up to 15,000 users through iSafePro VISOR 360 software.

It can be completely autonomous or centralised by iSafePro Visor 360 software. Equipped with a **MIFARE RFID** reader, it can recognise users in 1-to-1 or 1-to-many mode.

Its interface with a 2.8" colour touch screen allows **rapid local configuration** and use of a keypad for entering a code.

- Native TCP/IP
- Colour touch screen
- Event log

4 Operating modes:

- ✓ Fingerprint in badge
- ✓ Fingerprint only
- ✓ Code + Fingerprint
- ✓ Code only



Technical specifications

- Up to 500 users (2 fingerprints per user) in standalone mode or up to 15,000 users through iSafePro Visor 360 software
- Last 15,000 events recorded
- 128 time slots
- EEPROM and FLASH memory
- Optical biometric sensor
- Enrolment time of 5 seconds or less
- Identification time of 1 second or less
- Adjustable security level
- Size of recognition zone: 14 x 22 mm
- Integrated 3A/250V relay for opening control management
- Push button input
- Door contact input (monitoring of door status)
- Conditional input (monitoring of intrusion system status)
- Automated system open collector output (e.g. activation/deactivation of an intrusion system)
- 2.8" touch screen for local configuration
- Ethernet connection for connecting to the network (configuration by iSafePro 360 Visor software)
- RS485 BUS for V-EXTIO input/output card management (e.g. for lift management)
- Self-protection output (gives the status of the self-protection switch integrated in the reader)
- WIEGAND outputs for central access control stations
- Power supply: 12 / 24 volts
- Consumption: 500 mA
- Dimensions: 170 x 82 x 90 mm
- Operating temperature: -10 C to +50 C
- Relative humidity: 0 to 95 %
- Protection level: IP54

Options and accessories

DIGI1300

- Centralised enrolment module for Visor software

DIGI USB

- MIFARE USB encoder for Visor software

V-EXTIO

- 8-input/8-output module

iSafe VISOR 360 – Supervision and Access Management Software



Our iSafePro 360 Visor latest generation supervision and access management software is the tool which allows you to control access within your structure with **complete flexibility**.

Equipped with many user assistance features and capable of managing up to 840 readers. **Intuitive and ergonomic**, it is **very simple** to use and easy to install.

Visor software allows you to view one or more sites and combines **interactivity and technology** to guarantee optimum access control.

- Many user assistance features
- Ergonomic customisable software
- Badge printer management
- Biometrics management
- Voice messages

Technical specifications

- Management of 1 to 840 doors
- Compatibility: Windows 7, XP, Vista
- Access or SQL Server database configurable at the time of creation of the site
- Automatic detection of control stations connected
- Software customization by creation of shortcuts for the most commonly used functions
- Automated systems with scenarios
- Data import
- Management of 3 crisis levels
- Lift management with free access per floor
- Unlimited manager profiles
- Overview of site(s) with real-time status of door inputs/outputs and readers
- Configurable listings, exports for printing and /or sending by E-mail
- Time and attendance



A PERFECT MATCH

High level integration with many powerful Open management components.

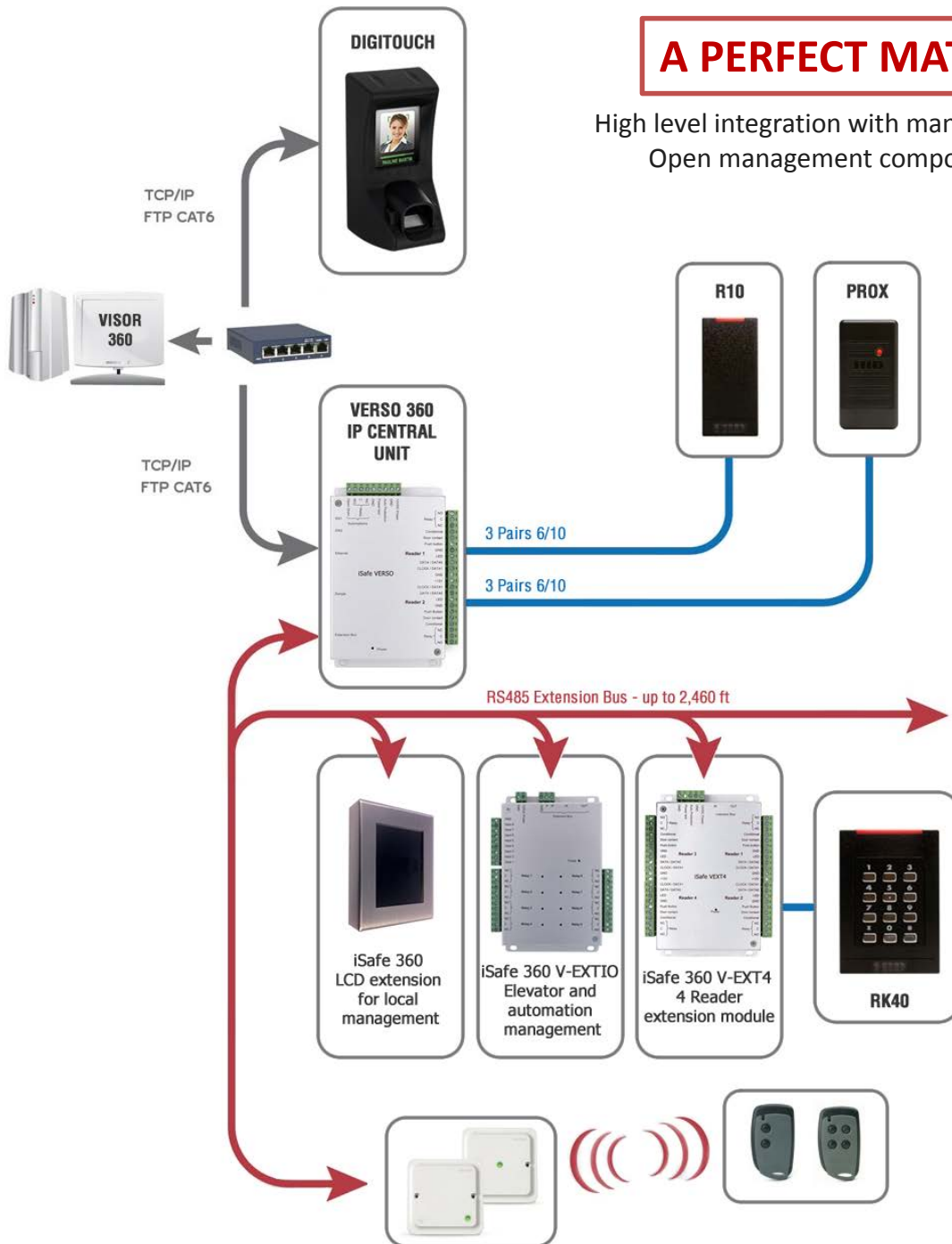

iSafePro VISOR 360 Software

- ◆ 15,000 Identifiers
- ◆ Management of 1 to 840 access doors
- ◆ Supports all protocols
- ◆ Supports offline functionality
- ◆ Active mapping
- ◆ Compatibility: W7-XP-Vista
- ◆ Multi-Language
- ◆ Supports Access or SQL Server database
- ◆ Software Dongle for added security
- ◆ Random code management

www.immotec.ca





Immotec systems, inc.
5000 Yonge Street, Unit # 1901, Toronto, ON M2N7E9
Tel: 416-741-4555 E-mail: info@immotec.ca URL: www.immotec.ca